

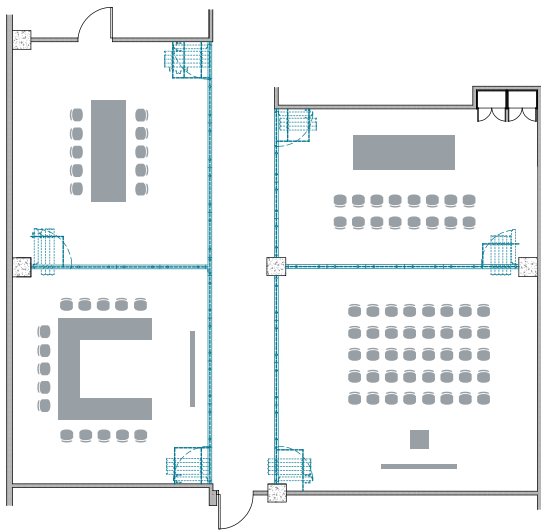

GS100 Double Glazed Movable Wall System

**GS100 Double Glazed Movable Wall System
at 'The Wesleyan Assurance Society, Birmingham'**

Having won the project to refurbish six floors of the Wesleyan Assurance Society's building in Birmingham on a design and build basis, City Office Interiors Ltd identified that the Executive seventh floor required a very high level of bespoke finishes.



After carrying out a detailed evaluation of the various systems available, City Office Interiors selected Duvale's GS100 double glazed movable wall for use on this executive floor to create a training and meeting area offering both flexibility of space and the specified very high standard of finish.

Supplied and installed by Duvale distributor, Creatif Moving Walls of Leeds, the GS100 system enables one large area to be easily subdivided in different ways to provide a maximum of four completely separate areas; each of which is independently accessible since each wall incorporates its own pass door.

The layout of the walls has been specially developed so that, when the area is configured for four separate areas, a corridor between them is created to provide access to another part of the building which is reached via the training area.

Walls are 'top hung' so that there are no tracks at floor level which could create a health and safety hazard. Each double glazed module is fitted with two roller suspensions which have been developed to ensure ease and quietness of movement. Each module incorporates a concealed internal jacking system to enable it to be locked securely in place when the wall is in the 'closed' position so that maximum sound resistance is achieved and sound transference between adjacent areas is thus minimised.

In this particular instance, manifestation applied to the glass creates privacy between areas but the system can also be supplied with manually or electronically operated blinds which are fitted within the double glazing.

GS100 Double Glazed Movable Wall System

Winterpick Business Park, Hurstpierpoint Road, Wineham, Henfield, West Sussex BN5 9BJ
t 0870872 0873 f 0870 872 0874 e sales@duvale.plc.uk www.duvale.plc.uk
London Showroom: The Octagon, Exchange Tower, 2 Harbour Exchange Square, London E14 9GE

duvale plc
movable wall manufacturers